

FLAT HEAD PART HEXAGON BODY OPEN BLIND RIVET NUT

● A2 Stainless Steel (AISI304)

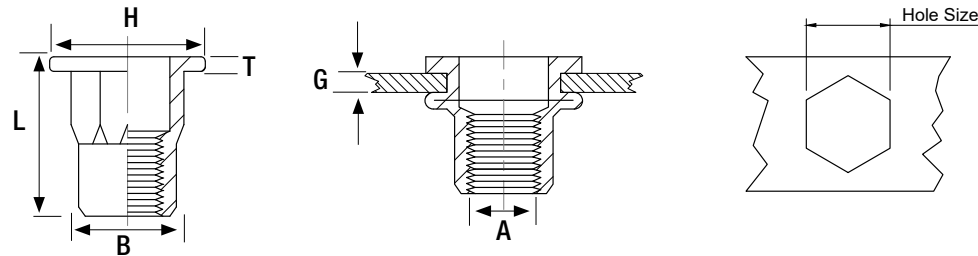

Thread Size mm (A)	Article Number	Grip Range Min mm (G)	Grip Range Max mm (G)	Hole Size mm	Body Diameter mm (B)	Flange Diameter mm (H)	Flange Thickness mm (T)	Body Overall Length mm (L)	Max Tightening Torque Nm	Tensile Strength N	Box Quantity	Price £ Per 1000
M4	RNSSFHPH0425	0.5	2.0	6.0	5.9	9.0	0.8	11.0	4.0	6800	1000	£199.65
M5	RNSSFHPH0535	0.5	2.5	7.0	6.9	10.0	1.0	12.0	6.5	10000	1000	£212.12
M6	RNSSFHPH0635	0.5	3.0	9.0	8.9	12.7	1.5	15.5	12.0	15000	500	£234.01
M8	RNSSFHPH0835	1.0	3.5	11.0	10.9	15.0	1.5	18.0	31.0	27000	250	£365.71
M10	RNSSFHPH1040	1.0	4.0	13.0	12.9	17.0	1.8	21.0	42.0	28500	250	£636.29

Grip range and test data are guide figures only